

Digital2™

**5200** MAH

PORTABLE BATTERY

*PREMIER*

**USER MANUAL**  
**DP-5200F**

*U.S Service Hotline : 1-888-863-0138*  
*More support at [www.d2pad.info](http://www.d2pad.info)*

## Package Contents

- 5200 mAh Portable Battery
- Micro USB to USB Cable
- User Manual

- 1 Micro USB Port
- 2 Lightning Cable for iPhone & iPad
- 3 Battery Indicators
- 4 Power Button
- 5 Micro USB for Smartphone & Tablet 5VDC, 0.5A max

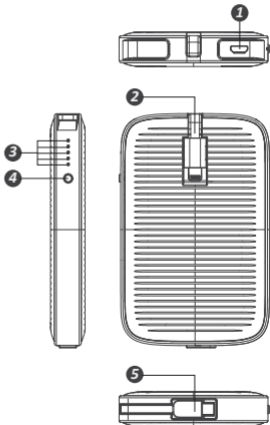

# Charging Mobile Devices

---

1. Fully Recharge the Portable Battery by connecting it to a computer or an USB wall charger with the included Micro USB to USB Cable.
2. Press the power button for 2 seconds to turn the portable battery on.
3. Connect your mobile devices to the corresponding charger and verify charging takes place.

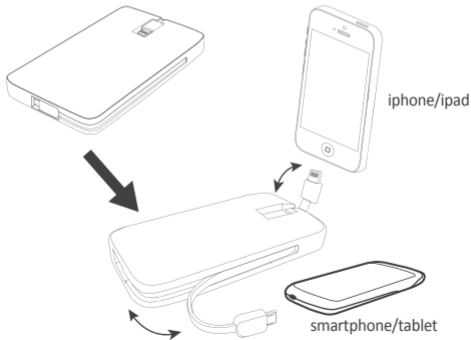

# Portable Battery Operation

---

## Battery Indicator

- Press the power button and the LED lights will indicate the battery level as shown below.

LEDs	1 LED	2 LEDs	3 LEDs	4 LEDs	5 LEDs
Battery level	1-20%	21-40%	41-60%	61-80%	81-100%

- When the portable battery is off, press and hold the power button for 2 seconds to turn it on.
- The portable battery will turn off automatically when no devices are connected to the portable battery or the portable battery has been fully charged.
- To show the remaining power level in the portable battery, simply press the power button once.
- When the portable battery's power level reaches 1% or less, the LED light will flash for 30 seconds and the portable battery will turn off.

## Recharging - Input

- The current an USB power source can provide determines the speed the portable battery will be charged at. Below is an approximate charging time from 0% to 100% in different currents.

	Max. charging current	Charging time
iPad wall charger(2.1A)	1.8A	3.5 hours
iPhone wall charger(1A)	1.0A	6.5 hours
Computer etc.(0.5A)	0.5A	12.5 hours

# Portable Battery Operation (cont.)

---

## Charging Device - Output

- The battery has 2 outputs, Lightning connector at 2.1A max, and Micro USB connector at 0.5A.
- Total combined output by the portable battery is 2.6A max.  
The portable battery can charge two devices simultaneously.

## Safety

- The portable battery has short-circuit protection, over-current protection, over-charge/discharge protection, current limit, etc.
- When the internal battery in the portable battery is protected/deactivated, there will be no current output to charge your devices. In this case, disconnect all devices from the portable battery, then plug the portable battery to a USB power source with the included Micro USB to USB cable. The portable battery will be able to activate and function properly again.
- In certain rare situation, controller inside the portable battery freezes up due to abnormal operation, the portable battery cannot turn on, charge a device, or be recharged, the LED battery indicators will not light up. In this case, unplug all devices from the portable battery first. Next, press and hold down the power button while connecting the portable battery to an USB power source. The portable battery will reset and resumes functionality.

## FCC WARNING

This device complies with part 15 of the FCC rules.

Operation is subject to the following two conditions :

- (1) this device may not cause harmful interference, and
- (2) this device must accept any interference received, including interference that may cause undesired operation.

# Warranty

---

Digital2 offers a ONE YEAR limited warranty for all Digital2 Portable Battery units, limited to those residing in the 48 continental United States and Canada.

Digital2 warrants the products to be free from defects in materials and workmanship as sold to the original purchaser. This warranty is for replacement for like-items only and do not cover items out of production if the company no longer stocks them. This warranty is not assignable. Third-party products, such as mobile/ handheld devices, media players, camcorders, cameras, tablets, etc. interacting with the Digital2 products are not covered by this warranty.

Digital2's sole obligation under this warranty is to replace or, at its option, to repair, free of charge, all the product's defective parts. This warranty applies only on the condition that the product has been installed, maintained, and operated under conditions of normal use and in accordance with the installation guide provided. The provisions of this warranty shall not apply if, in Digital2's sole judgment, the product has been subject to misuse or neglect, improper installation, accidental damage, or repaired or altered in ways that affect its performance or reliability.